

13 March 2018



**AUCKLAND
INSTITUTE
OF STUDIES
NEW ZEALAND**

- Please read the attached instructions.
- Please bring your student ID card with you.
- Phones, other electronic devices and watches of any type are not permitted in exams. Possession of any such items during exams will result in severe penalties.
- If you are not enrolled in a course and / or your fees are not up-to-date, you are not entitled to sit exams.

Examination Timetable – Semester 1, 2018

Information Technology Programme

Monday 23 April 2018		VENUE
Time: 9.00am – 12.15pm	7.201 Systems Analysis and Design (Practical and Theory Exam)	AM10
	7.316 Business Intelligence (Theory Exam)	Sport Hall
Time: 1.30pm – 4.45 pm	7.101 The Information Technology System (Theory Exam) and 2.112 IT Concepts	Sport Hall
Tuesday 24 April 2018		
Time: 9.00am – 12.15pm	7.103 Fundamentals of Computer Programming (Practical and Theory Exam) 7.105 Fundamentals of Computer Networking (Practical and Theory Exam)	AM10
	7.314 E-Business Strategies (Theory Exam)	Sport Hall
Time: 1.30pm – 4.45 pm	7.309 Network System Security (Practical and Theory Exam)	AM10
Wednesday 25 April 2018		
Public Holiday		
Thursday 26 April 2018		
Time: 9.00am – 12.15pm	7.104 Database Engineering I (Practical and Theory Exam) 7.218 Server Administration (Practical and Theory Exam)	AM10
	Time: 1.30pm – 4.45 pm	7.219 E-Commerce Management (Theory Exam) and 2.265 E-Commerce for Managers
Friday 27 April 2018		
Time: 9.00am – 12.15pm	7.217 Requirement Modelling (Theory Exam) 7.301 Information Technology Project Management (Theory Exam)	Sport Hall
	Time: 1.30pm – 4.45 pm	7.202 System Testing (Practical and Theory Exam)

SEMESTER 1, 2018 EXAMS

These exams will be held in different rooms at the Asquith Campus.

It is your responsibility to make sure you arrive at the exam room 10 minutes before your exam starts.



ASQUITH CAMPUS

Toilets

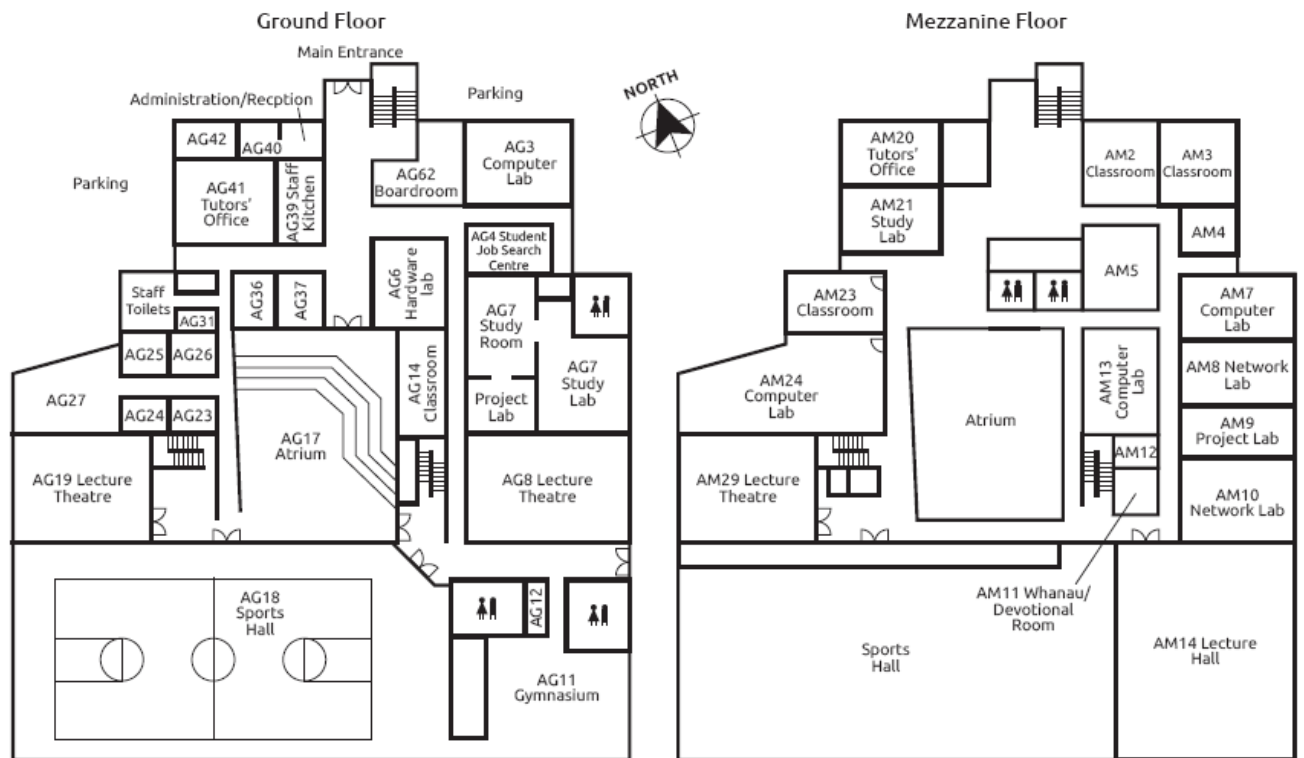

IMPORTANT EXAM INFORMATION

**Bring your ID CARD to all exams – please check the expiry date on your card
and have your card renewed if necessary
NO ID = NO ADMITTANCE to the exam**

Mobile Phone and Other Electronic Devices and Watches (digital and analogue)

- Switch it off
- Put it in your bag or give it to the exam supervisor at the door
- **If you are found with a phone, watch or other device on your person during the exam this is considered cheating even if it is switched off. A penalty will be applied which may be zero marks for the exam or a reduction in marks for the exam, plus a major demerit point.**

Pencil Cases

- Remove the pens, pencils, ruler, eraser, white ink that you require from your pencil case
- Do not take your pencil case to the table where you are sitting
- **Please bring more than one pen**

Caps and hats

- Remove your cap / hat and put in your bag or leave it with the exam supervisor at the door

Dictionaries

- You are **NOT ALLOWED** to bring a dictionary into the exam room
- If you need to use a dictionary during the exam please ask a supervisor for one – not all courses permit the use of dictionaries.

Calculators

- If you need to use a calculator for your course please bring your own – we cannot provide calculators for students
- Only calculators that lie FLAT on the desk are permitted
- Calculators with an angled display are **NOT ALLOWED**
- Calculators with graphic display, text-storing function, built-in word processing, dictionary function or with the ability to communicate electronically with any other devices are specifically forbidden.

NO Personal Digital Assistants (PDAs) or Removable Drives are allowed to be brought into any exam room.

Practical Exam by using laptop

- Students may only use their AIS-issued laptop.
- Students may not use a wireless mouse.

Cheating Includes:

- Having notes in electronic devices, written on paper, on your hand or any other part of your body.
- Looking at another student's work.
- Helping another student.
- Trying to access websites and applications other than those specified in the exam or exam instructions.
- Talking to another student in the exam room.
- Having a cell phone or other electronic device with you (put it in your bag or give it to an exam supervisor before the start of the exam).

If you are caught cheating you will have to appear before the Student Disciplinary Committee – no exceptions!!

PLEASE LISTEN TO THE EXAM SUPERVISORS CAREFULLY AND FOLLOW ALL THEIR INSTRUCTIONS. GOOD LUCK WITH YOUR EXAMS